

Short Hire Technical Specifications



Park Theatre
11-13 Clifton Terrace
Finsbury Park
LONDON
N4 3JP

May 2025

Useful Contacts:

Technical Manager: Gian.Zona@parktheatre.co.uk
Deputy Technical Manager: Teddy.Nash@parktheatre.co.uk
General Manager: Tom.Bailey@parktheatre.co.uk
Head of Ticketing: Matthew.Barker@parktheatre.co.uk
Administration: Mariah.Sayer@parktheatre.co.uk

Please contact with the relevant department to find out more information.

Important Information

All the information in this document is subject to change based on what events are currently on in Park 90. Depending on staging, setup and configuration, there may be some restrictions or considerations that must be discussed with the relevant team in Park Theatre.

There is very limited storage space on site. Should your event require pre-emptive storage, please contact Park Technical directly.

If you have a Technical Rider, please send it to the Technical Team - technical_dept@parktheatre.co.uk

Any show waste must be taken away by the company.

The Space

The space size is dependent on the configuration of the current show and any set they might have.

The average playing space is approx. 5m x 4m.

Lighting

Lighting Desk: ETC ION Classic

There will always be access to a general wash & House lights fader. These are made using the current in-house shows rig and as such, subject to their focus.

Any external equipment hired or owned by the visiting company must be PAT tested prior to use at Park Theatre and related paperwork must be provided.

Sound

Sound Desk: Yamaha MG16XU (subject to availability).

There will typically be at least 2 speakers in the grid focused towards the seating banks. For specific playback or microphone needs please contact the technical team.

Other Sound Information

A mini-Jack input could be set up for playback. Wired and Wireless Mics can also be made available (subject to availability), prices available on request.

If you wish to use any other supplementary types of sound equipment such as monitors, not detailed in this spec, please contact the technical team directly.

Any externally sourced radio equipment used on Park Theatre premises must not infringe on frequencies used in house and/or other visiting companies and must be licenced. Park Theatre reserves the right to instruct visiting companies to control the frequencies of radio equipment should any issues arise. Please feel free to contact Park Technical for details of current frequencies used.

Power Distribution

13A General local power outlets are located on the Gantry level and in the backstage area. Extension leads may be available upon request.

Set and Stage

The Hire will be on top of the current running show, so please bear in mind that there will be limitations to what can be achieved. Please contact Park Technical Department directly and we can advise for more information. For example, Lino might need to be rolled out to protect the floor.

Available For Hire

Upon request can provide the following technical equipment (subject to availability):

If you wish to use any equipment, please let the technical team know in advance.

Park Theatre may be able to supply some other consumable items at a cost- Flints black paint, painting equipment, Flamebar, tape. Prices available on request.

Equipment
Wireless Hand-held Microphone
Sure SM58
Christie LX605 Projector
Yamaha Digital Piano

The Building

Dressing Rooms

Park Theatre Dressing Rooms may be available, please get in touch with our team for more information.

Backstage Washroom Facilities

Two unisex toilets, one of which is accessible, plus two unisex showers.

Laundry

There is a communal laundry room with a washing machine and tumble dryer backstage. This is for the use of all companies.

General Information

The space has air conditioning and skylight windows, which can be controlled on request. Show relays (switchable between our two spaces) feed to the BOH areas.

Access/Parking

Get-in access is through the front doors of Park Theatre on Clifton Terrace.

Park Theatre cannot offer any parking. On Sundays the parking restrictions outside the theatre are exempt. However, as we are located close to Arsenal Football stadium, full parking restrictions are in place (even on a Sunday) when there is an Arsenal home match.

Items coming into Park90 must comfortably fit through a doorway measuring W1004mm x H2040mm.

There is a small passenger lift that can be used to transport larger items from street level to corridor. The lift has a maximum weight capacity of 630kg. Any damage caused to the lift will be charged to the event.

Thank you & have a great event!

— For reference, below are the configurations that P90 might be in —

THRUST1

86 Seats
+1 Usher

Park Theatre, Park90
 January 2018
 SCALE: 1:40 @ A3
 Technical Manager
 Gleen.Zoua@parktheatre.co.uk
 Deputy Technical Manager
 Teddy.Stash@parktheatre.co.uk

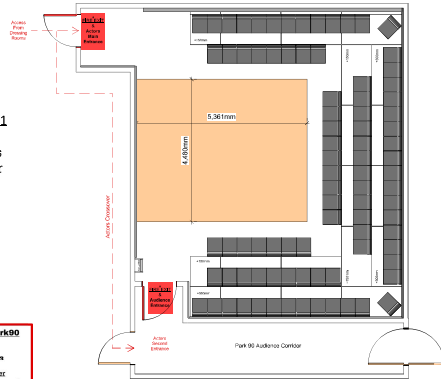

PARK 90

THRUST1 (Extra Row)

93 Seats
+1 Usher

Park Theatre, Park90
 January 2018
 SCALE: 1:40 @ A3
 Technical Manager
 Gleen.Zoua@parktheatre.co.uk
 Deputy Technical Manager
 Teddy.Stash@parktheatre.co.uk

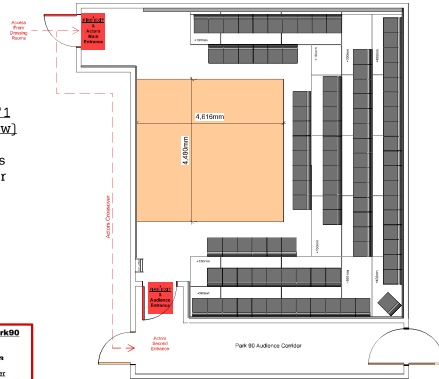

PARK 90

THRUST2

81 Seats
+1 Usher

Park Theatre, Park90
 January 2018
 SCALE: 1:40 @ A3
 Technical Manager
 Gleen.Zoua@parktheatre.co.uk
 Deputy Technical Manager
 Teddy.Stash@parktheatre.co.uk

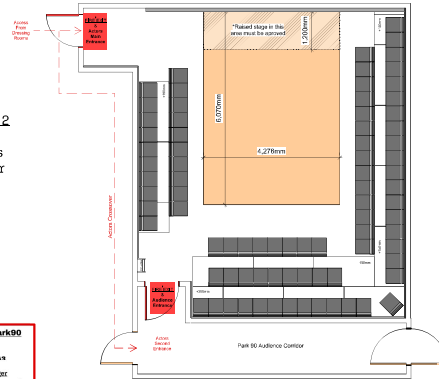

PARK 90

SET DESIGN, PLEASE NOTE:
 If you plan to raise the stage above floor level in the hatched area of the playing space shown on this seating configuration - this will need to be Risk Assessed by your own and must be approved by Park Technical.
 In addition, if you raise the floor here you may need to provide an ADG at stage level to ensure your Risk Assessment Plan, Evacuation Plan.

L-SHAPE

91 Seats
+1 Usher

Park Theatre, Park90
 January 2018
 SCALE: 1:40 @ A3
 Technical Manager
 Gleen.Zoua@parktheatre.co.uk
 Deputy Technical Manager
 Teddy.Stash@parktheatre.co.uk

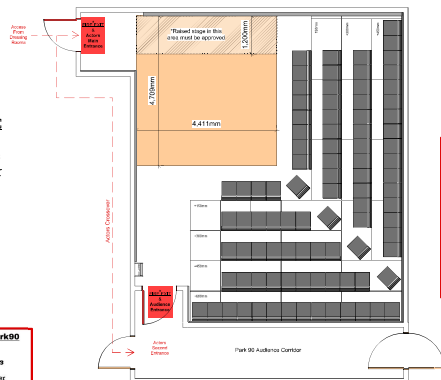

PARK 90

SET DESIGN, PLEASE NOTE:
 If you plan to raise the stage above floor level in the hatched area of the playing space shown on this seating configuration - this will need to be Risk Assessed by your own and must be approved by Park Technical.
 In addition, if you raise the floor here you may need to provide an ADG at stage level to ensure your Risk Assessment Plan, Evacuation Plan.

IN THE ROUND

93 Seats
+1 Usher

Park Theatre, Park90
 January 2018
 SCALE: 1:40 @ A3
 Technical Manager
 Gleen.Zoua@parktheatre.co.uk
 Deputy Technical Manager
 Teddy.Stash@parktheatre.co.uk

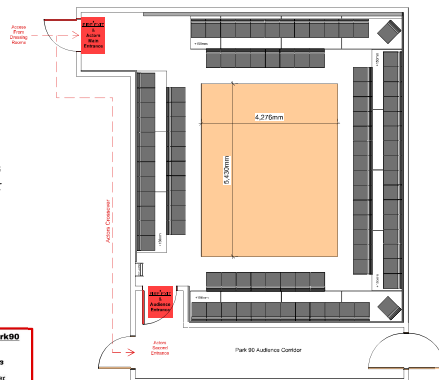

PARK 90

IN THE ROUND (Extra Long Row)

101 Seats
+1 Usher

Park Theatre, Park90
 January 2018
 SCALE: 1:40 @ A3
 Technical Manager
 Gleen.Zoua@parktheatre.co.uk
 Deputy Technical Manager
 Teddy.Stash@parktheatre.co.uk

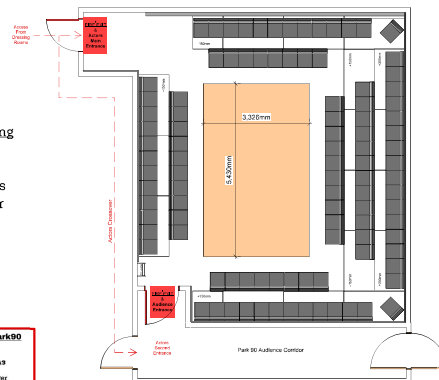

PARK 90

IN THE ROUND (Extra Short Row)

97 Seats
+1 Usher

Park Theatre, Park90
January 2024
SCALE: 1:40 @ A3
Technical Manager
Glan.Zoua@parktheatre.co.uk
Deputy Technical Manager
Teddy.Steah@parktheatre.co.uk

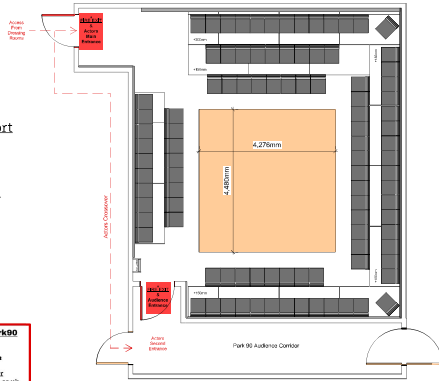

Park Theatre
Glan.Zoua@parktheatre.co.uk
January 2024
SCALE: 1:40 @ A3
Technical Manager
Glan.Zoua@parktheatre.co.uk
Deputy Technical Manager
Teddy.Steah@parktheatre.co.uk

TRAVERSE 75 Seats +1 Usher

Park Theatre, Park90
January 2024
SCALE: 1:40 @ A3
Technical Manager
Glan.Zoua@parktheatre.co.uk
Deputy Technical Manager
Teddy.Steah@parktheatre.co.uk

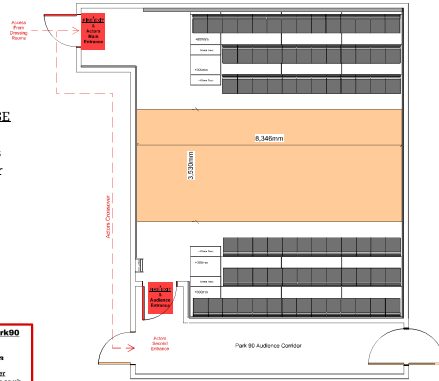

Park Theatre
Glan.Zoua@parktheatre.co.uk
January 2024
SCALE: 1:40 @ A3
Technical Manager
Glan.Zoua@parktheatre.co.uk
Deputy Technical Manager
Teddy.Steah@parktheatre.co.uk

TRAVERSE (Extra Row)

87 Seats
+1 Usher

Park Theatre, Park90
January 2024
SCALE: 1:40 @ A3
Technical Manager
Glan.Zoua@parktheatre.co.uk
Deputy Technical Manager
Teddy.Steah@parktheatre.co.uk

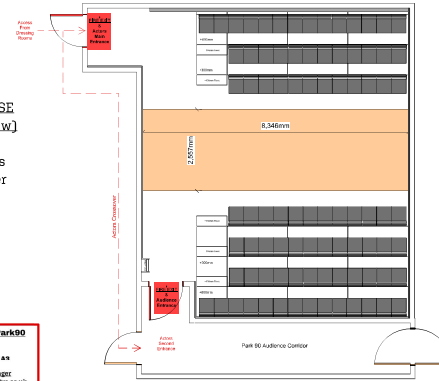

Park Theatre
Glan.Zoua@parktheatre.co.uk
January 2024
SCALE: 1:40 @ A3
Technical Manager
Glan.Zoua@parktheatre.co.uk
Deputy Technical Manager
Teddy.Steah@parktheatre.co.uk

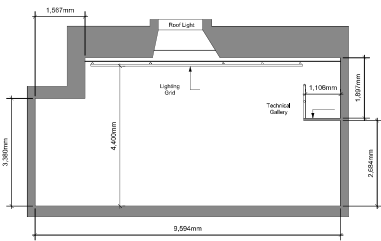

Section Through Park 90

Park Theatre, Park90
January 2024
SCALE: 1:40 @ A3
Technical Manager
Glan.Zoua@parktheatre.co.uk
Deputy Technical Manager
Teddy.Steah@parktheatre.co.uk

Park Theatre
Glan.Zoua@parktheatre.co.uk
January 2024
SCALE: 1:40 @ A3
Technical Manager
Glan.Zoua@parktheatre.co.uk
Deputy Technical Manager
Teddy.Steah@parktheatre.co.uk